

PVX-240

# PREXISO

- EN VIDEO BORESCOPE
- DE VIDEO-ENDOSKOP
- FR ENDOSCOPE VIDÉO
- IT BOROSCOPIO VIDEO
- ES BOROSCOPIO DE VIDEO
- NL VIDEOBESCOOP
- TR VIDEO ENDOSKOP
- DK VIDEOENDOSKOP
- FI VIDEO ENDOSKOOPPI
- NO VIDEOENDOSKOP
- PL BOROSKOP WIDEO
- SV VIDEOBORESKOP

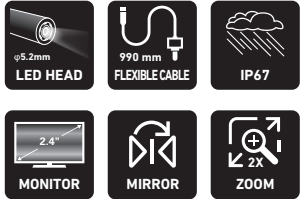
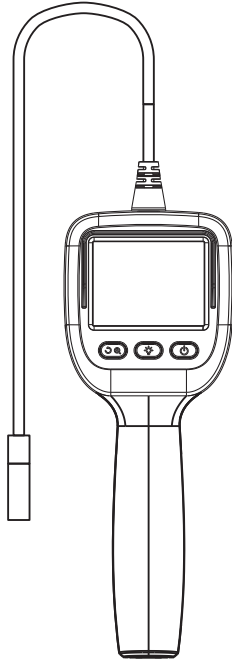

[www.prexiso-eu.com](http://www.prexiso-eu.com)

## FEATURES

- 5.2mm smaller camera head allow to reach smaller area for easy visual inspections.
- Image rotation on monitor allows better orientation, zoom 1.5times and zoom 2 times can see the details better.
- 6 adjustable LEDs allow day and night viewing.
- Waterproof Camera, flexible 990mm cable, twist and lock attachment.
- Hook and magnet accessories helpful in retrieval.
- Lightweight, compact, easy carry and storage.

## PACKING LIST

- Handle with LCDscreen x 1
- Mirror x 1
- Magnet x 1
- Single Hook x 1
- Carry bag x 1
- AA batteries x 4

## STRUCTURE

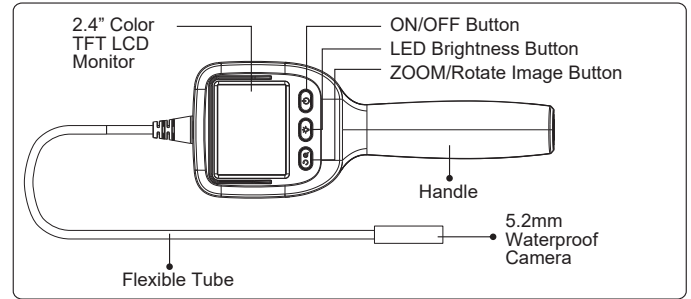

## INSTALLATION

### Accessories Installing:

Slide an attachment over the base of the camera(see Figure, right). Over the base of the camera, gently squeeze the black mounting module at the bottom of the attachment until hooked.

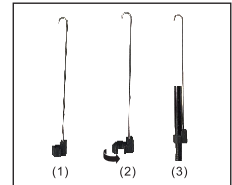



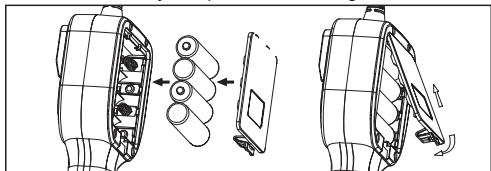

### Batteries Installing:

1. Open the battery compartment cover.
2. Insert four new batteries into the battery compartment. Make sure the polarity of the batteries is correct in the process.
3. Close the battery compartment cover again so that it locks into place.



### OPERATIONS

1. ON/OFF: Press and hold the  button for 3 seconds. If users can't turn on, please replace the batteries.
2. LED brightness adjustment: Press the  button and adjust the LED illumination level until the maximum value is reached. When the button is pressed again, the LED light is off.
3. ZOOM/ROTATE: Short press the  button to enlarge the image.  
Press once: Picture is magnified 1.5 times.  
Press 2X: Picture is magnified 2 times.  
Press 3X: Picture is displayed in its original position.  
Press and hold the  button to flip the image. The figure to the right demonstrates how the image is adjusted for each button press.

ROTATE

ROTATE

ROTATE

ROTATE

**Warning: Permanent damage to the flex tube and loss of operation will occur if the flex tube is subjected to narrow radius or sharp angle bends.**

### SPECIFICATIONS

Model No.	Parameter
Screen Size	2.4" TFT LCD
Power Supply	AA x 4 batteries(1.5V x 4)
Imaging Sensor	1/9-inch CMOS
Effective Pixels	640 x 480
Field of view	52±5°
Diameter of camera head	5.2mm
Waterproof capacity	IP67(for lens/tube only)
Cable length	990mm
Dimensions of handle	198 x 75 x 42(mm) (Excluding Flexible Tube)
Operating temperature	-10°C~50°C/14°F~122°F
Operating humidity	15~85%RH
Approx. weight	254g±5g (Including batteries)

※All specifications are subject to minor change without prior notice.

### FCC INFORMATION

Note: This equipment has been tested and found to comply with the limits for a Class B digital device, pursuant to part 15 of the FCC Rules. These limits are designed to provide reasonable protection against harmful interference in a residential installation. This equipment generates, uses and can radiate radio frequency energy and, if not installed and used in accordance with the instructions, may cause harmful interference to radio communications. However, there is no guarantee that interference will not occur in a particular installation. If this equipment does cause harmful interference to radio or television reception, which can be determined by turning the equipment off and on, the user is encouraged to try to correct the interference by one or more of the following measures:

- Reorient or relocate the receiving antenna.
- Increase the separation between the equipment and receiver.
- Connect the equipment into an outlet on a circuit different from that to which the receiver is connected.
- Consult the dealer or an experienced radio/TV technician for help.

Changes or modifications not expressly approved by the party responsible for compliance could void the user's authority to operate the equipment.

This device complies with Part 15 of the FCC Rules.

Operation is subject to the following two conditions:

- (1) this device may not cause harmful interference, and (2) this device must accept any interference received, including interference that may cause undesired operation.

### EU Environmental Protection

Waste electrical products should not be disposed of with household waste. Please recycle where facilities exist. Check with your local authority or retailer for recycling advice.



Made in China