

IMPORTANT:  
Read before Using

EN

# PREXISO

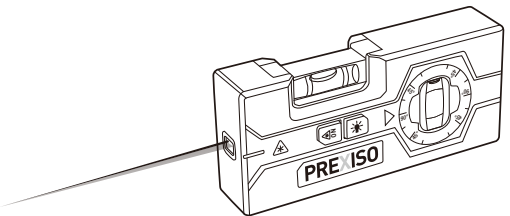

P1P3M

## 2-IN-1 COMPACT MAGNETIC LASER TORPEDO LEVEL



www.prexiso-eu.com

P1P3M-05REV01-2404

1

### SAFETY INSTRUCTIONS

Working safely with the measuring tool is possible only when the operating and safety information are read completely and instructions contained herein are strictly followed. Never make warning labels on the measuring tool unrecognizable. **SAVE THESE INSTRUCTIONS.**

Caution – The use of operating or adjusting equipment or the application or processing methods other than those mentioned herein, can lead to hazardous radiation exposure.



Laser radiation-Do not stare into beam.  
<1.0mW @ 630-670nm IEC/EN 60825-1:2014 Complies with 21 CFR 1040.10 and 1040.11 except for conformance with IEC 60825-1 Ed. 3, as described in Laser Notice No. 56, dated May 9, 2019. Class 2 Laser product.



### WARNING

**LASER RADIATION.** Do not stare into beam. Class II laser product. Turn the laser beam on only when using this tool.

- Do not remove or deface any product labels.
- Avoid direct eye exposure. The laser beam can cause persons being blinded.
- Do not operate the tool around children or allow children to operate the tool.
- Do not place the tool in a position that may cause anyone to stare at the laser beam, whether intentionally or unintentionally.
- Do not use on reflecting surfaces such as sheet steel, glass or polished metal etc. that have shiny, reflective surfaces. The shiny surface could reflect the beam back at the operator.
- Always turn the laser tool off when not in use. Leaving the tool on increases the risk of someone inadvertently staring into the laser beam
- Do not attempt to modify the performance of this laser device in any way. This may result in a dangerous exposure to laser radiation.
- Do not attempt to repair or disassemble the laser-measuring tool. If unqualified persons attempt to repair this product, serious injury may occur. Any repair required on this laser product should be performed only by qualified service personnel.
- Use of other accessories that have been designed for use with other laser tools could result in serious injury.
- Do not operate the tool outdoors.
- Do not place or store tool under extreme temperature conditions.

2

- Do not operate the tool in explosive environments, such as in the presence of flammable liquids, gases or dusts. Sparks can be created in the tool which may ignite the dust or fumes.
- Measurement may not be accurate if used beyond the rated range of the device.
- The use of optical instruments with this product will increase eye hazard.
- Always make sure any bystanders nearby aware of the dangers of looking directly into the measuring tool.
- Do not use the laser viewing glasses as safety goggles, they do not protect eyes against laser radiation.
- Always remove the batteries when cleaning the laser light aperture to laser lens.
- Always remove the batteries if you are not using the instrument for a long time. Ensure that the battery polarity connections are correct when replacing batteries.

### TECHNICAL SPECIFICATIONS

COMPONENT	SPECIFICATIONS
Laser line Range	Up to 30ft/10m(indoor use) *
Laser line accuracy	±3/8" @30'(±10mm/10m) *
Laser wavelength	630-670nm
Laser class	II, <1mW
Horizontal vial accuracy	0.043"(0.75mm/m)
Working temperature	0 ~ 40°C
Storage temperature	-10~ 60°C
Batteries	1 x 1.5V (AAA)
Operating time	> 3H
Weight	0.29lb(132g) without batteries
Dimension	4.8 x 2.2 x 1.1 in. (120 x 55 x 26 mm)

\*Important: The accuracy is rated within distance of 10 meters. Under unfavorable conditions, such as in extreme interior illumination, transparent surfaces (eg. glass, water), porous surfaces (eg. insulation materials) or reflecting surfaces (eg. polished metal, glass) or very rough surfaces (eg. rough cast, natural stone), the tool's measuring range and accuracy will be reduced.

3

### DESCRIPTION

#### 2-IN-1 COMPACT MAGNETIC LASER TORPEDO LEVEL

This is a highly versatile tool, the combination of torpedo level and line laser level. It can be placed on the ground, mounted on a door frame, work bench etc.

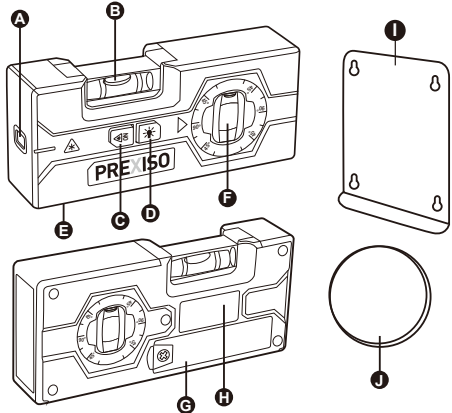

PARTS	DESCRIPTION
A	Laser outlet
B	Horizontal vial for alignment
C	Laser ON/OFF switch
D	LED light ON/OFF switch
E	Magnetic V-groove
F	Rotatable vial
G	Battery compartment
H	Magnet for iron wall mount plate
I	Iron wall mount plate
J	Reusable double sided mounting gel pad

### UNPACKING

When unpacking the box, do not discard any packing materials until all of the contents are accounted for:

- 2-IN-1 compact magnetic laser torpedo level
- 1 x AAA alkaline battery

4

- Iron wall mount plate
- Reusable double sided mounting gel pad
- Operator's manual

Carefully lift the laser tool out of the package and place it on a stable, flat surface.

### ASSEMBLY

#### INSERTING/REPLACING THE BATTERY

1 x AAA alkaline battery is recommended for the measuring tool. Open the battery compartment lid with PH #1 Philips screwdriver or 3mm slotted screwdriver. Insert the battery provided. Pay attention to the correct polarity of the battery according to the representation on the metal plate inside the lid.

**NOTE:** Remove the battery from the tool when not using it for extended periods. When storing for extended periods, the battery can corrode and discharge themselves.

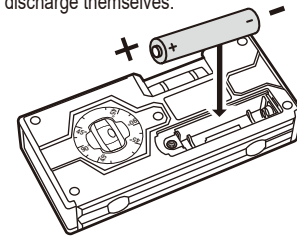

### OPERATION

#### 1. TO TURN THE LASER TOOL ON AND OFF

Push the [ON] button, the laser tool will project a laser beam out of the laser outlet. Push the [OFF] button again, the laser beam will be turned off.

Push the [LED] button, the LED light in the horizontal bubble will light up. Push the [LED] button again to turn it off.

Note: This measuring tool is equipped with LED light in the horizontal bubble, which is convenient for tasks in dark area.

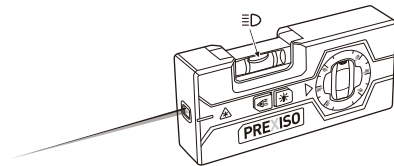

5

**NOTE:** The distance between the laser outlet and the base is 1.06 in. (27mm)

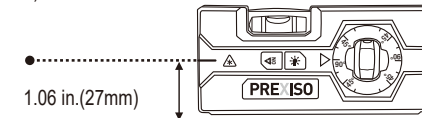

#### 2. LEVELLING

This 2-IN-1 compact magnetic laser torpedo level is not of self leveling function. You can use the horizontal bubble to get the horizontal line with bubble in the middle for marking. And you can use the rotating bubble to confirm the inclination of the laser line or vertical angle. You can also adjust the rotating bubble to 22.5°, 45°, 67.5° and 90° for quick angle setting.

This laser level is equipped with a magnet backside, you can connect the laser level to the iron wall mount plate, then connect and fix the laser level with iron wall mount plate on the wall surfacing by nailing. You can connect the laser level to smooth surfaces with the provided reusable double sided mounting gel pad.

#### Note:

- The gel pad may be washed and used repeatedly. To maintain good adhesion, wash the gel pad frequently. Make sure the gel pad is cleaned of any dust or debris before usage.
- Do not use the gel pad to fasten onto the wall if the wall surface is loose or wet, to avoid laser level from dropping.
- Always keep the target wall surface clean for gel pad usage.

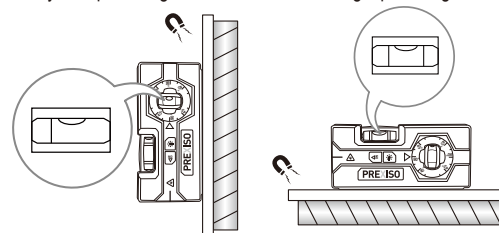

6

### APPLICATIONS

The tool can be placed on the ground, mounted on a work bench / door frame etc. It is an ideal tool for line marking and simple alignment by sight.

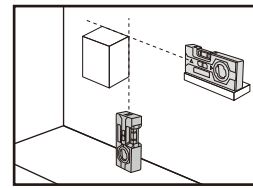

LINE APPLICATION

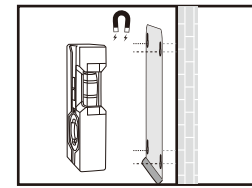

WITH IRON WALL MOUNT PLATE

### MAINTENANCE

This compact magnetic laser torpedo level has been designed to be a low-maintenance tool. However, in order to maintain its performance, you must always follow these simple directions:

- Avoid exposing the tool to shock, continuous vibration or extreme hot or cold environment.
- Always store the tool indoors.
- Always keep the tool free of dust and liquids. Use only a clean soft cloth for cleaning. If necessary, slightly moisten the cloths with pure alcohol or a little water.
- Do not disassemble the compact laser measuring tool, this will expose the user to hazardous radiation exposure.
- Do not attempt to change any part of the laser lens.

### TROUBLESHOOTING

PROBLEM	CAUSE	SOLUTION
The LED bubble light is weak.	Battery is weak.	Replace with new battery.
The laser line is hard to see.	The tool is out of the rated operating range	Move the tool closer to be within the rated operating range.
Laser line is not projected, or LED bubble light is not on.	No batteries installed or batteries are depleted, or battery is weak.	Install or replace new battery.

7

### DISPOSAL

#### CAUTION

The batteries must not be disposed with household waste. Care for the environment and take them to the collection points provided in accordance with national or local regulations. Dispose of the product appropriately in accordance with the national regulations in force in your country. Adhere to the national and country specific regulations.



### WARRANTY

Two-Year Limited Warranty. This product is warranted to the original purchaser from the original purchase date for two years subject to the warranty coverage described herein. Please retain your receipt. This product is warranted to the original user to be free from defects in material and workmanship. If you believe that the product is defective at any time during the specified warranty period, please contact Prexiso customer service agent by sending email to info@prexiso-eu.com. This warranty does not cover: (1) Part failure due to normal wear or product abuse; (2) Any parts have been altered or modified by anyone other than an authorized Prexiso personnel or failure to install and operate equipment according to the guidelines put forth in the instruction manual. (3) Any products or parts used for rental purposes, damage resulting from shipping (claims must be filed with freighter), accident, abuse, act of God, misuse, or neglect. Prexiso will replace or repair the defective unit, at its option, subject to verification of the defect. Any implied warranties arising from the sale of a Prexiso product, including but not limited to implied warranties of merchantability and fitness for a particular purpose, are limited to the above. Prexiso shall not be liable for loss of use of the product or other incidental or consequential damages, expenses, or economic loss, or for any claim of such damage, expenses, or economic loss. This warranty excludes any accessories. This warranty gives you specific legal rights, and you may also have other rights that vary from state.

Made in China



Prexiso AG  
Fabrikstrasse 1  
CH-8586 Erlen /Switzerland  
www.prexiso-eu.com

8